



STERLING ARMS  
INTERNATIONAL

SAI R9 MK1

# Owner's Manual

This manual must be read in its entirety BEFORE using the firearm.

Failure to use this firearm in its prescribed manner may result in injury or death to user or bystanders.

KEEP THIS MANUAL WITH YOUR RIFLE. IF YOU SELL THE RIFLE, GIVE THIS MANUAL TO THE NEW OWNER.

**WARNING: IT IS YOUR RESPONSIBILITY TO ASSURE THAT YOUR FIREARM IS HANDLED, FIRED, AND STORED SAFELY AND RESPONSIBLY AT ALL TIMES.**

This manual provides instructions on the operation and maintenance of your Sterling Arms International Inc. (SAI) **R9 MK1** rifle system.

**Read and understand it carefully before you try to use your firearm.**

Your safety, and that of those around you, depends on your knowledge of your firearm and on your knowledge of safety rules common to all firearms. Please study the common-sense safety rules noted in this manual.

Your first responsibility as a gun owner is always safety!

This manual may serve several models of SAI firearms. Ensure you identify which specific model you possess and follow those instructions and guidelines.

#### **NOTICE**

SAI and affiliates has no control over the use of your firearm, and shall not be responsible for injury, death, or damage to property resulting from either intentional or accidental discharge of this firearm. In addition, SAI shall not be responsible for proper function of the firearm when it is used for purposes or subjected to treatment for which it was not intended. SAI will not honour claims which may result from careless or improper handling, unauthorized adjustments or parts replacement, corrosion, neglect, use of the wrong type or caliber of ammunition, or the use of ammunition other than original, high quality commercially new manufactured ammunition in good condition or any combination thereof.

#### **THE VITAL FOUR ACTS OF FIREARMS SAFETY**

- **Assume** every firearm is loaded.
- **Control** the muzzle direction at all times.
- Trigger finger must be kept **off the trigger** and out of the trigger guard.
- See that the firearm is unloaded - **PROVE** it safe.

#### **PROVE**

- **Point** the firearm in the safest available direction.
- **Remove** all cartridges.
- **Observe** the chamber.
- **Verify** the feeding path.
- **Examine** the bore.

**ALWAYS** WEAR EYE AND EAR PROTECTION. MAKE SURE THAT NEARBY BYSTANDERS ALSO WEAR EYE AND EAR PROTECTION.

HANDLING OF CARTRIDGES AND FIRING FIREARMS MAY EXPOSE YOU TO LEAD. ALWAYS ASSURE THAT THERE IS ADEQUATE VENTILATION. ALWAYS WASH YOUR HANDS AFTER HANDLING AMMUNITION OR FIRING YOUR FIREARM.

**WARNING:** GRIPPING THE FIREARM LOOSELY WHEN FIRING CAN CAUSE THE SHOOTER TO FIRE TWO SHOTS (THE SECOND AS THE TRIGGER STRIKES THE SHOOTER'S TRIGGER FINGER DURING COUNTER-RECOIL.) THIS IS A SHOOTER ERROR, NOT A FIREARM MALFUNCTION.

THE FIRED CARTRIDGE CASE IS HOT WHEN IT IS EJECTED FROM THE FIREARM. DO NOT ALLOW IT TO BURN YOU OR TO DISTRACT YOU FROM SAFE HANDLING OF THE FIREARM.

**ALWAYS** ENSURE THAT THE CHAMBER IS EMPTY. THE FIREARM SHOULD NOT BE CONSIDERED TO BE SAFE UNLESS THE MAGAZINE IS REMOVED, THE SAFETY IS ON, AND THE BOLT / SLIDE IS OPEN, AND THE CHAMBER IS EMPTY.

**WARNING:** ALWAYS ASSUME ALL FIREARMS ARE LOADED. ANYTIME YOU HANDLE A FIREARM, YOU SHOULD IMMEDIATELY INSPECT IT TO ENSURE THAT IT IS COMPLETELY UNLOADED.

**WARNING:** DO NOT APPLY LUBRICANT OR PRESERVATIVE TO YOUR AMMUNITION. DOING SO MAY CAUSE THE CARTRIDGE TO PARTIALLY MALFUNCTION, LEAVING THE BULLET LODGED IN THE BORE, CREATING A BORE OBSTRUCTION.

**WARNING:** LEAD MAY BE PRESENT IN THE FOULING OF A DIRTY FIREARM. AVOID CONTACT WITH IT, AND CLEAN HANDS AFTERWARD TO AVOID INGESTING LEAD.

**CAUTION:** NEVER MIX TWO OR MORE BORE CLEANING SOLVENTS. SOME COMBINATIONS OF SOLVENTS PRODUCE ACIDS THAT MAY DAMAGE THE FIREARM OR HARMFUL VAPOUR THAT CAN CAUSE INJURY TO THE USER.

## TABLE OF CONTENTS

<b>Section</b>	<b>Title</b>	<b>Page</b>
<b>1</b>	SAFE STORAGE	<b>5</b>
<b>2</b>	GENERAL INFORMATION	<b>5</b>
<b>3</b>	SPECIFICATIONS	<b>5</b>
<b>4</b>	EXPLODED PHOTOS AND PARTS LISTS	<b>6-11</b>
<b>5</b>	AMMUNITION	<b>11</b>
<b>6</b>	INITIAL ASSEMBLY, INSPECTION, AND CLEANING.	<b>12</b>
	INITIAL ASSEMBLY	<b>12</b>
	INITIAL INSPECTION	<b>12</b>
	INITIAL CLEANING	<b>12</b>
<b>7</b>	BREAKING IN BARREL	<b>12</b>
<b>8</b>	LOADING AND FIRING	<b>13</b>
	LOADING THE MAGAZINE	<b>13</b>
	CHAMBERING AND FIRING A ROUND	<b>14-16</b>
<b>9</b>	CLEARING / UNLOADING THE FIREARM	<b>17-19</b>
<b>10</b>	DISASSEMBLY	<b>19-21</b>
	BOLT CARRIER GROUP	<b>22</b>
	UPPER RECEIVER	<b>23</b>
<b>11</b>	MAINTENANCE	<b>23</b>
	CLEANING LUBRICANTS AND LUBRICATION	<b>24</b>
<b>12</b>	REASSEMBLY	<b>24</b>
<b>13</b>	FUNCTION TEST / CHECK	<b>24-25</b>
<b>14</b>	TROUBLESHOOTING	<b>26-27</b>
<b>15</b>	WARRANTY, SERVICE, AND SUGGESTIONS	<b>28</b>

## 1. SAFE STORAGE

Always ensure that before storing your SAI R9 MK1, it is UNLOADED.

When you retrieve your R9 MK1 from storage, assume it is LOADED and PROVE the firearm "SAFE" for the safety of yourself and bystanders.

## 2. GENERAL INFORMATION

Your SAI R9 MK1 a lightweight, simple Blow Back operated, air cooled, magazine fed semiautomatic rifle. The R9 MK1 series are semi-automatic pistols chambered for the 9mm cartridge

## 3. SPECIFICATIONS

### Weight

	18,6" Barrel		10 " Barrel	
Rifle without Magazine:	3.1 Kg	6.83 Lbs.	2,86 Kg	5.8 Lbs.
Rifle with Loaded Magazine (5 rounds of 9x19mm ammunition)	3.35 Kg	7.38 Lbs.	3.31 Kg	6.2 Lbs.

### Length

	18,6" Barrel		10 " Barrel	
With fully collapsed stock	958 mm	37.7 Inches	740 mm	29.1 Inches
With fully extended stock	1020 mm	40.15 Inches	796 mm	31.3 Inches

### Barrel

Barrel material is AISI-SAE 4140 (42CrMo4) Material, 18.6 in. length, 6 groves with a 1 to 10 twist rate and flash hider muzzle.

### Calibre

9x19 mm

**Warning:** This SAI rifle system was designed to function properly with the original components as supplied. Alterations, repairs or replacing with non-SAI parts without written authorization in advance may render the firearm to operate unsafely. For the safety of the user and bystanders; do not alter or substitute parts and components.

SAI R9 MK1

Left hand View

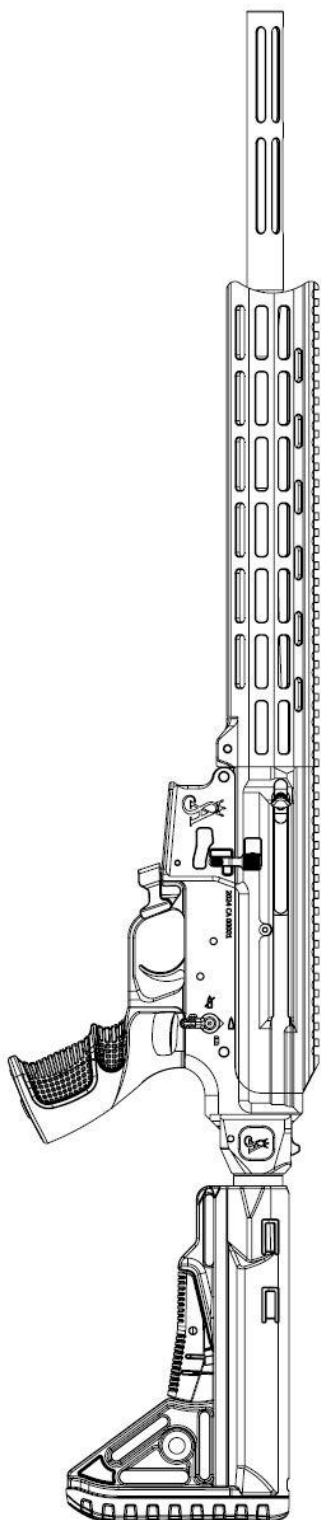

Right Hand View

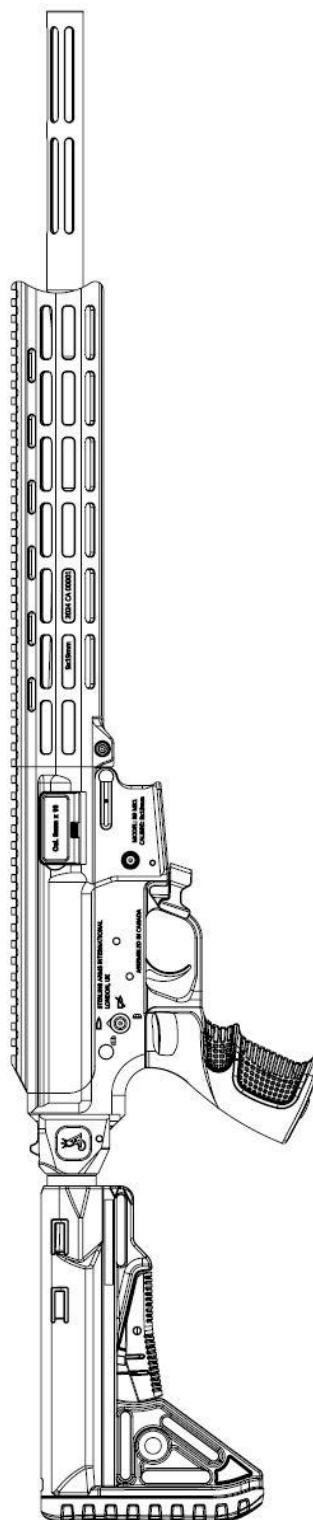

#### 4. EXPLODED PHOTOS AND PARTS LISTS

The photos and associated parts lists in this section will give you visual references to parts discussed in the text. In the text, you will note part numbers in parentheses behind some part names. Those part numbers are the same as part numbers shown in the exploded photos and part lists. For example, a part numbered “U-7” in the text would refer to the part numbered “7” in the Upper Receiver Group exploded photo and in its associated parts list.

##### SAI R9 MK1 UPPER RECEIVER GROUP

Part #	Quantity	Description	
U1	1	Upper Receiver	
U2	1	Dust Cover	
U3	2	Dust Cover Detent Spring	
U4	1	Dust Cover Detent	
U5	1	Coiled Pin (1.5x6 mm)	
U6	1	Dust Cover Pin Spring	
U7	1	Dust Cover Pin	
U8	1	Ejector	
U9	1	Ejector Screw (M4x6)	
U10	1	Firing Pin Safety Screw (M5x6)	
U11	1	Barrel Nut	
U12	1	Handguard Retaining Screw Lower (T10)	
U13	1	Handguard Retaining Screw Upper (T20)	
U14	1	Bolt	
U15	1	Extractor Spring	
U16	1	Extractor	
U17	1	Extractor Pin	
U18	1	Firing Pin Spring	
U19	1	Firing Pin	
U20	1	Firing Pin Retaining Pin	
U21	1	Firing Pin Safety Lock Spring Plug	
U22	1	Firing Pin Safety Lock	
U23	1	Firing Pin Safety Lock Pin	
U24	1	Guide Rod	
U25	1	Guide Rod Ring	
U26	1	Guide Rod Spring	
U27	1	Back Plate	
U28	1	Back Plate Roll Pin	
U29	1	Cocking Handle Slide	
U30	1	Magnet 1/4"x1/8"	
U31	1	Cocking Handle	
U32	1	Handguard	
U33	1	Barrel 9mm	
U34	1	Cocking Handle Screw (M3x8)	

\*\*\*If the bolt body is replaced, headspace needs to be checked by a qualified gunsmith.

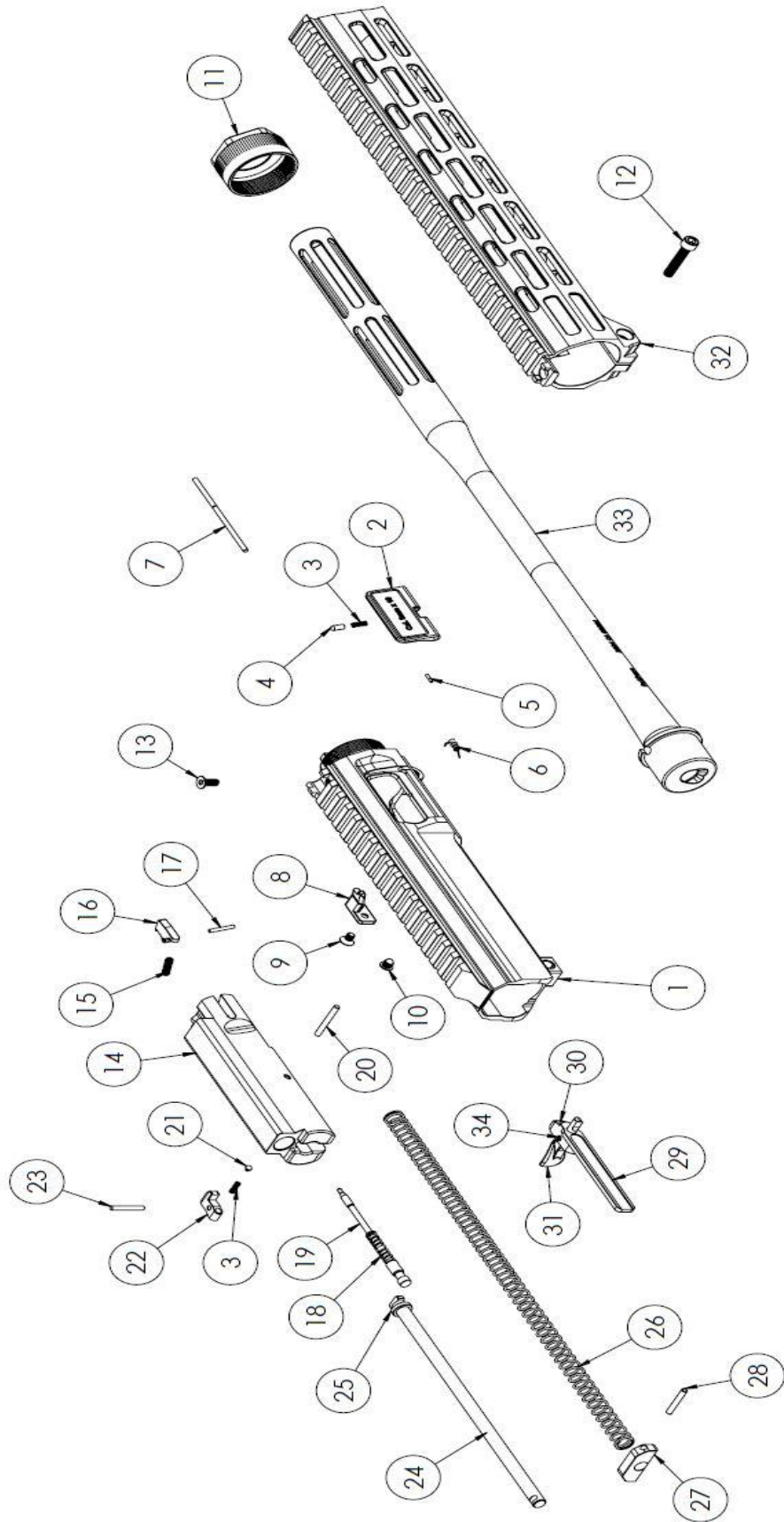



#### 4.A SAI R9 MK1 LOWER RECEIVER GROUP

Part	Quantity	Description	
L1	1	Lower Receiver	
L2	4	Bolt Catch Spring	
L3	3	Upper Adjustment Pin	
L4	3	Upper Adjustment Pin Cover	
L5	1	Magazine Release Button Spring	
L6	1	Magazine Release Contact Piece	
L7	1	Magazine Catch	
L8	1	Magazine Release Button	
L9	3	Magazine Release Button M3x8 Screw	
L10	1	Buffer Spring	
L11	1	Buffer	
L12	1	Buffer Screw	
L13	1	Trigger	
L14	1	Trigger Spring	
L15	1	Disconnecter Spring	
L16	1	Disconnecter	
L17	2	Trigger- Hammer Pin	
L18	1	Safety	
L19	1	Safety Selector Short	
L20	1	Safety Selector Long	
L21	1	Safety Pin	
L22	1	Safety Spring	
L23	1	Takedown Pin	
L24	2	Pivot- Takedown Pin Detent	
L25	2	Pivot- Takedown Pin Spring	
L26	1	Pistol Grip	
L27	1	Washer	
L28	1	Pistol Grip Screw	
L29	1	Pistol Grip Plug	
L30	1	Pivot Pin	
L31	1	Bolt Catch Spring Pin	
L32	1	Bolt Catch	
L33	1	Bolt Catch Coiled Pin $\varnothing$ 2.5x14	
L34	1	Magazine Release Lever	
L35	1	Magazine Release Lever Spring	
L36	1	Magazine Release Pin	
L37	1	Magazine Release Lever	
L38	1	Magazine Release Lever Screw	
L39	1	Hammer	
L40	2	Hammer Bushing	
L41	1	Hammer Spring	

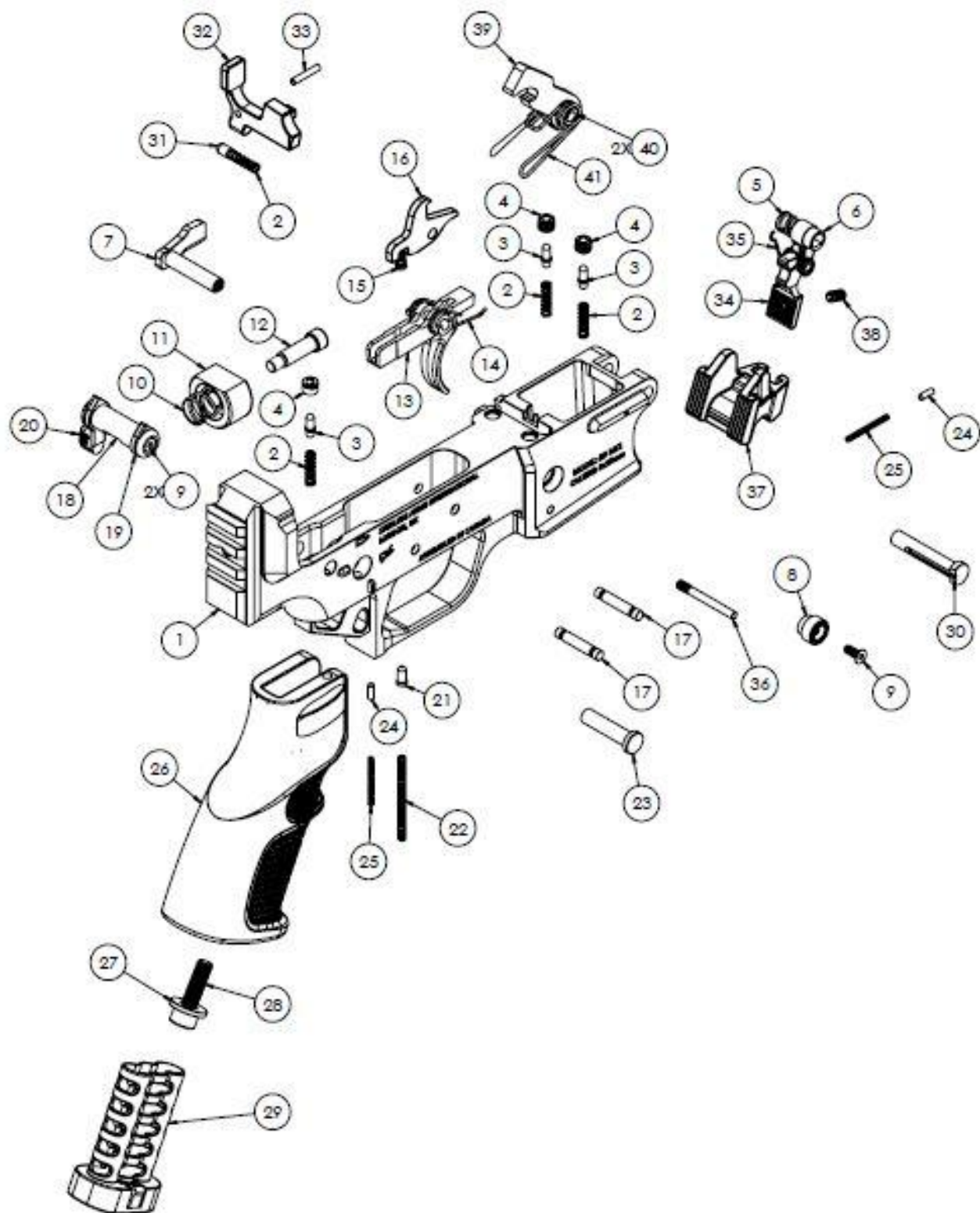

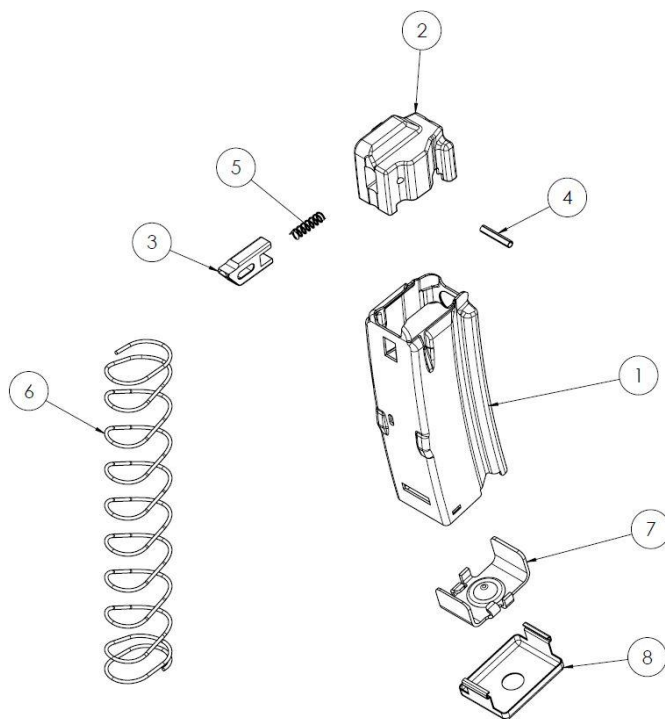

Part	Quantity	Description	
M1	1	Magazine Body	
M2	1	Follower	
M3	1	Bolt Catch latch	
M4	1	Coiled Pin Ø2.5x14	
M5	1	Bolt Catch latch Spring	
M6	1	Magazine Spring	
M7	1	Spring Locking Plate	
M8	1	Magazine Cover	

## 5. AMMUNITION

Ensure the data stamp of the ammunition matched the recommended ammunition for your SAI R9 MK1 rifle system. Using the wrong ammunition can cause injury or death to both the user and bystanders.

Firing any of the ammunition described in the below warnings/cautions will void your warranty.

**WARNING: USE OF INCORRECT AMMUNITION CAN CAUSE FIREARM DAMAGE, PERSONAL INJURY, OR DEATH. MAKE ABSOLUTELY CERTAIN THAT YOU ARE USING CARTRIDGES DESIGNED FOR YOUR FIREARM. DO NOT FIRE OLD, CORRODED, DEFORMED, OR HANDLOADED AMMUNITION.**

The SAI Rifle is chambered for 9x19 mm.

## **6. INITIAL ASSEMBLY, INSPECTION, AND CLEANING**

### **6.A INITIAL ASSEMBLY**

The SAI R9 MK1 is shipped to you with the stock detached. To attach the stock, pull rearward on the top thumb latch and slide the stock onto the rear vertical 1913 rail. The rifle has been test fired to ensure functionality.

#### **INITIAL INSPECTION**

Using this manual; physically check your SAI R9 MK1 to ensure all of the parts listed in each group is present and in the correct place. This manual will also assist you in familiarizing the user with the knowledge needed to safely and responsibly operate this firearm. Any time you disassemble and reassemble a firearm, you should conduct a functional check of it as described in the REASSEMBLY section of this manual.

### **6.B INITIAL CLEANING**

The SAI R9 MK1 has been test fired before shipping. It is normal for there to be a small amount of carbon materials in the bore / barrel during initial inspection.

To limit corrosion, the firearm has also been lightly coated with a preservative; including the bore. This must be cleaned and dried before firing as oil left in the bore may increase pressures when fired.

The initial pre-firing cleaning includes:

Clean the bore of your firearm and lubricate the firearm as described in the maintenance section below.

Before the firearm “settles”, a short break in period of up to 100 rounds is encouraged, which allows machined or phosphate-coated surfaces to deburr and self-polish.

## **7. BREAKING IN BARRELS**

SAI barrels are made of a very strong **CrMoV material but they are Melonited**. Do not use an abrasive to break in the barrel.

For optimum performance:

Before firing the first time, wet clean the bore and barrel. Ensure to pull 2 dry patches through before firing.

Fire one five round group and then clean the barrel with a wet patch followed by 2 dry patches. Repeat this process 4 times.

Your barrel is now sufficiently broken in and will allow the user to see the performance of the barrel.

As detailed in the maintenance section; it is recommended that the user clean the barrel and bore after every use, before storage.

## 8. LOADING AND FIRING

WARNING: THIS FIREARM WILL FIRE WITHOUT A MAGAZINE IN IT.

Before attempting to load the SAI R9 MK1, the user must ensure visually that the bore and barrel are free from any obstructions. Any obstruction can cause injury and/or death to the user and bystanders.

WARNING: ALWAYS KEEP THE SAFETY IN THE "SAFE" POSITION UNTIL YOU ARE READY TO FIRE THE FIREARM.

### 8.A LOADING THE MAGAZINE WITH AMMUNITION

Load the magazine with the correct ammunition by pressing the cartridges one at a time into the magazine's feed lips. When loading the rounds into the magazines ensure the base of the cartridge is in contact with the back of the magazine.

The magazine follower has a raised portion generally resembling the outline of a cartridge. Cartridges are loaded into the magazine so that the tips of the bullets point in the same direction as the raised portion of the follower.

Set the cartridge on the follower, between the feed lips, pointing the same direction as the bullet shape on the follower, and press it straight down until it's held by the lips of the magazine.

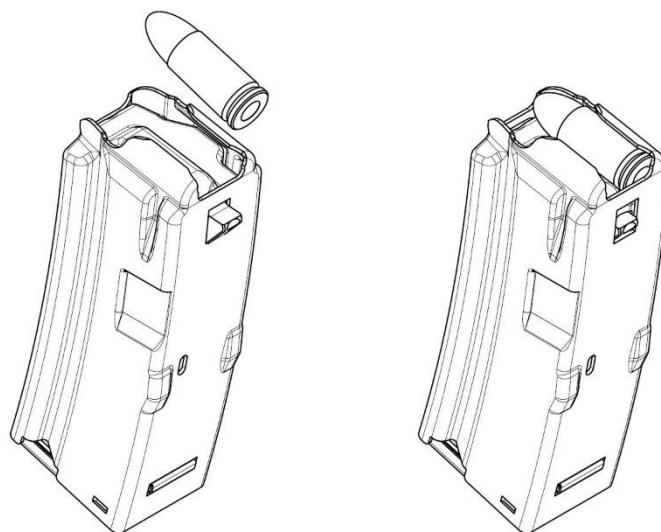

## 8.B LOADING THE MAGAZINE INTO THE FIREARM

With a firm grasp on the magazine, fully insert the top of the magazine into the magazine well, with the bullet tips facing forward towards the muzzle of the firearm. The magazine catch should fully lock the magazine in place.

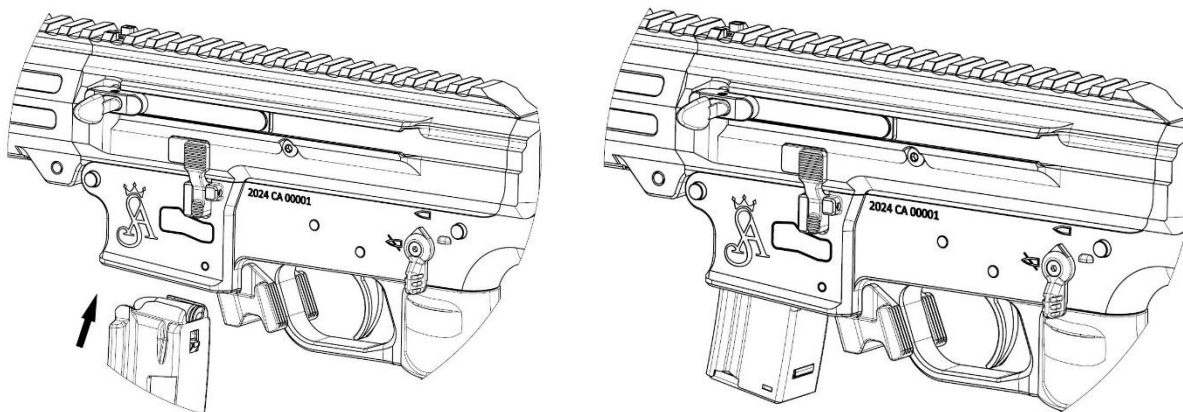

To ensure the magazine is properly seated, gently tug down on the magazine. If it stays in place, it is properly seated. If too much force is used to insert the magazine, the user may damage the feed lips and render the magazine useless for future use.

NOTE: The magazine may be inserted with the bolt carrier assembly open or closed.

## 8.C CHAMBERING A ROUND

**The user must ensure safe firearms handling**

1. Attempt to set the safety (L-20) to "SAFE"

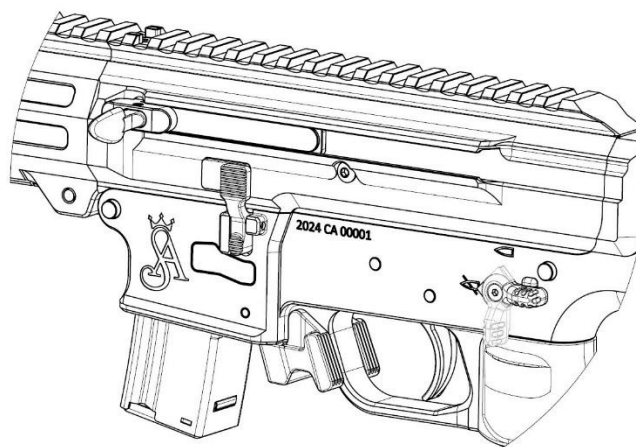

2. Hold the Quadrail handguard (U-32) of the rifle with one hand, pointing the muzzle in a safe direction. With the other hand, insert a loaded magazine into the magazine well.

3. If the bolt is open, grasp the charging handle (U-33) with the right hand. Pull it to the rear thus disengaging the bolt catch. Then release the charging handle. A round will be stripped from the magazine and loaded into the chamber.

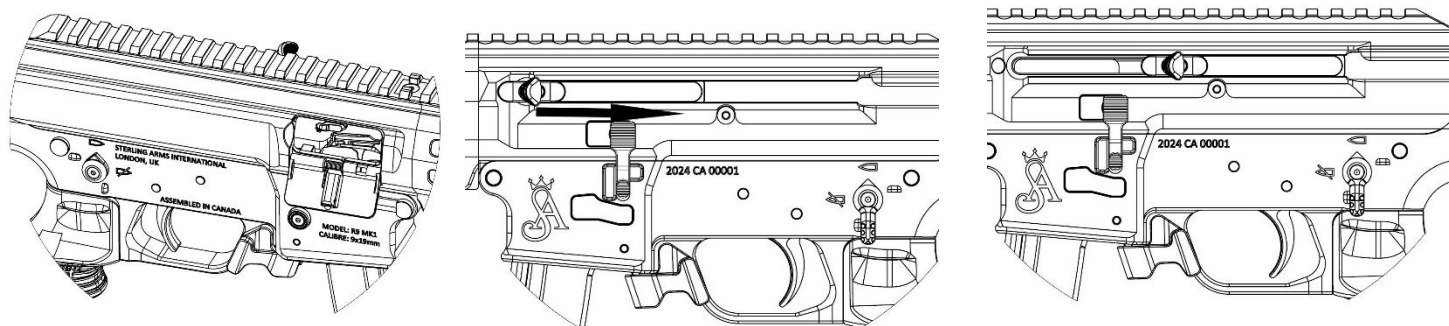

If the bolt is closed when the magazine is inserted, pull the charging handle (U-33) fully to the rear and release it. Do not assist in its forward movement. The SAI R9 MK1 needs the full power of the return springs to force the bolt into the fully closed position. If for some reason the bolt fails to go all the way forward; pull the charging handle in a rearward motion approximately **1/2 inches** and release.

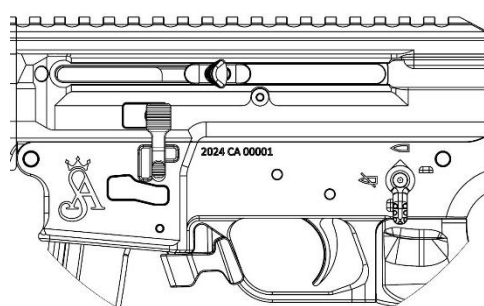
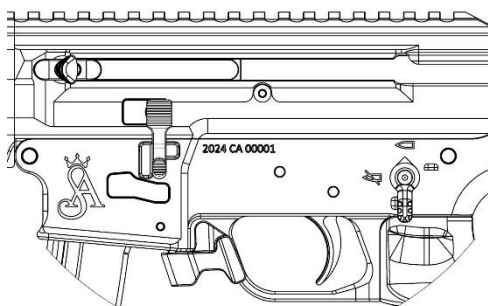
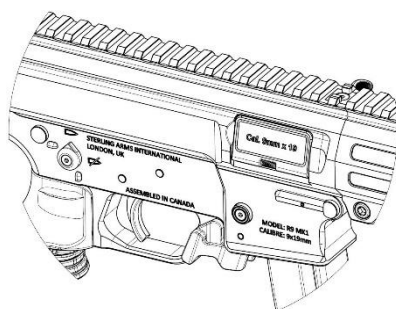

## 8.D FIRING A ROUND

The rifle is now loaded and ready to fire.

1. Aim the firearm, safely, at a target using the sights the user has affixed to the firearm.
2. Set the safety (L-20) to “FIRE.”
3. In a fluid motion, depress the trigger to the rear until the trigger group is activated and the firearm discharges.

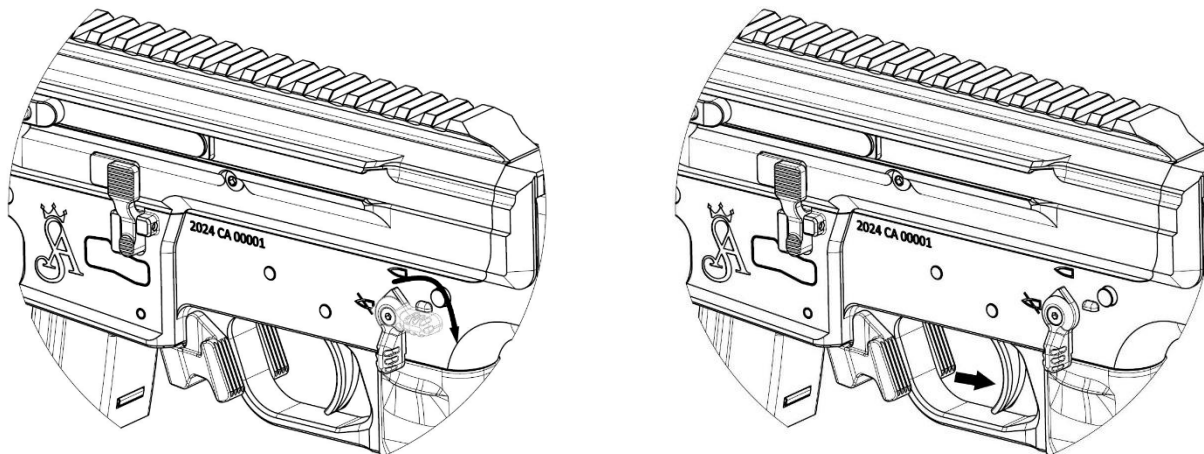

### **WARNING: IF THE FIREARM FAILS TO FIRE WHEN THE TRIGGER IS PULLED:**

1. KEEP THE FIREARM POINTED AT THE TARGET!!!
2. WAIT 60 SECONDS TO ALLOW A POSSIBLE “HANGFIRE” TO GO OFF. THEN,
3. CHECK TO SEE IF THE SAFETY IS ENGAGED BY MISTAKE. IF SO, PUSH THE SAFETY TO THE “FIRE” POSITION AND FIRE.
4. IF THE FIREARM STILL DOES NOT FIRE, BE CAUTIOUS AND ASSUME THAT THE CARTRIDGE WILL DISCHARGE WHEN THE BOLT/SLIDE IS OPENED.
5. OPEN THE BOLT/SLIDE QUICKLY, FULLY TO THE REAR TO UNLOAD THE ROUND THAT WAS LOADED IN THE CHAMBER FROM THE FIREARM. ENGAGE THE BOLT CATCH TO HOLD THE BOLT TO THE REAR.
6. EXAMINE THE FIREARM AND CARTRIDGE CAREFULLY TO IDENTIFY THE CAUSE OF THE MALFUNCTION.

**NOTE:** The SAI R9 MK1 is designed to use commercial style generically available magazines. Variations in both magazines and rifles may cause the bolt carrier to rub on the magazines feed lips. If the contact causes sluggish operation, remove a small amount of metal from the rubbed (shiny) area of the feed lips.



**CAUTION:** DO NOT REST THE RIFLE ON ITS MAGAZINE WHEN YOU ARE LOADING OR FIRING IT. DOING SO CAN FORCE THE MAGAZINE UP INTO THE RIFLE, REDUCING THE RELIABILITY OF FEEDING CARTRIDGES.

## 9. CLEARING / UNLOADING THE FIREARM

1. Attempt to place the safety (L-20) on “SAFE”.

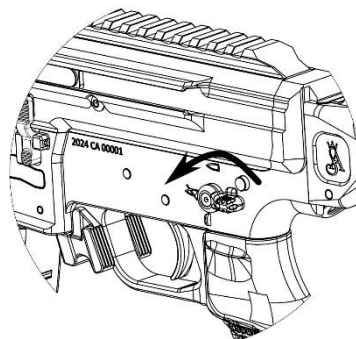

2. Remove the magazine from the rifle. While holding the pistol grip with one hand, use the thumb of the other hand to press the magazine release lever forward. Now, you can remove the magazine by pulling it down from the magazine slot.

You can also remove the magazine by pressing the magazine release button on the right side.

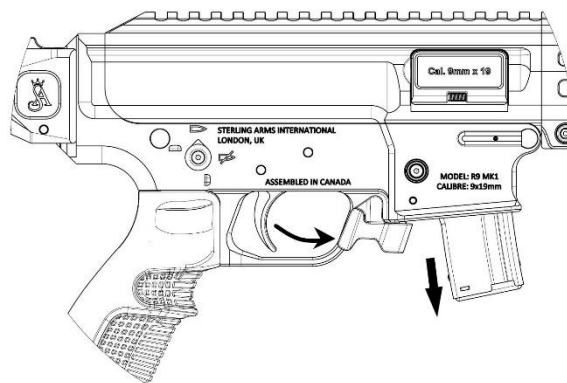
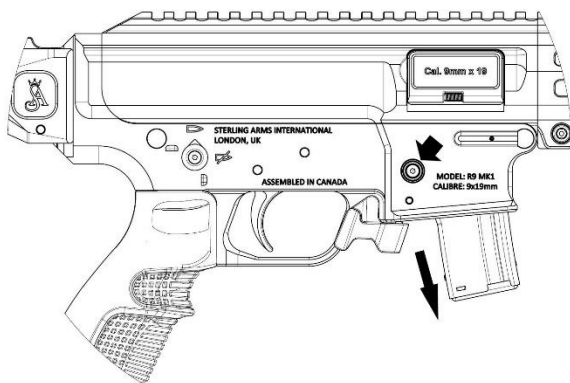
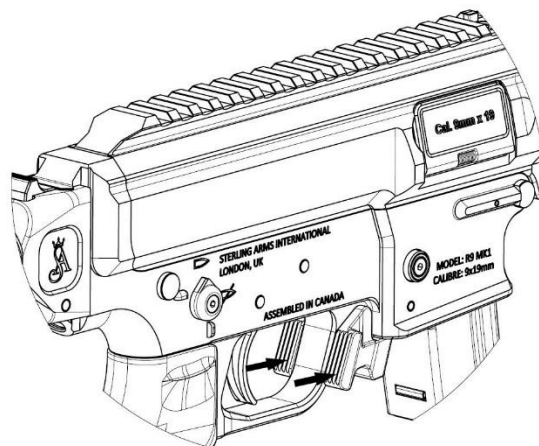
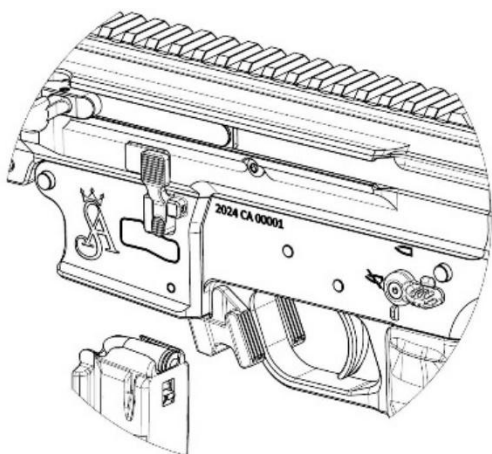

**NOTE:** If the firearm is not cocked, the safety cannot be set on “SAFE”.

3. Extract the cartridge (if any) from the chamber. To extract a cartridge, pull the bolt fully to the rear. If there is a cartridge in the chamber, it should be extracted and ejected from the firearm.

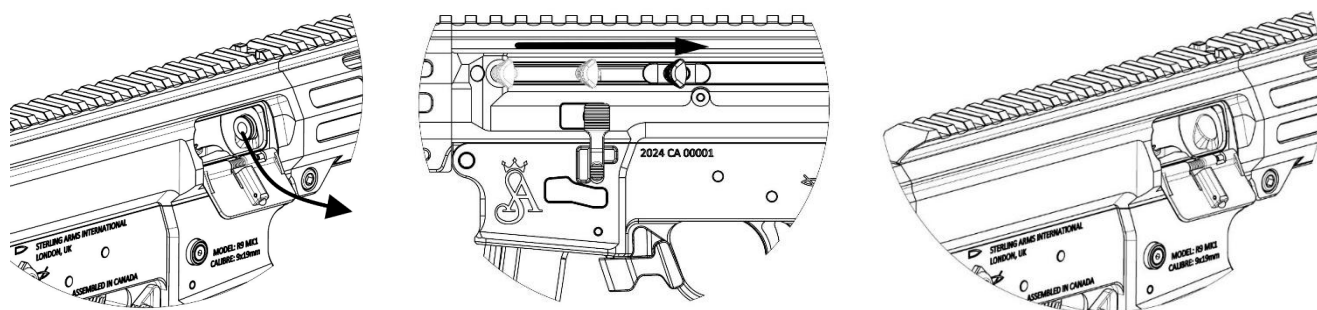

4. To lock the bolt open, pull the charging handle rearward, reach into the LEFT side of the magazine well, and press the bottom tab of the bolt catch (L-7) with a finger. Then ease the bolt forward until the bolt catch stops it.

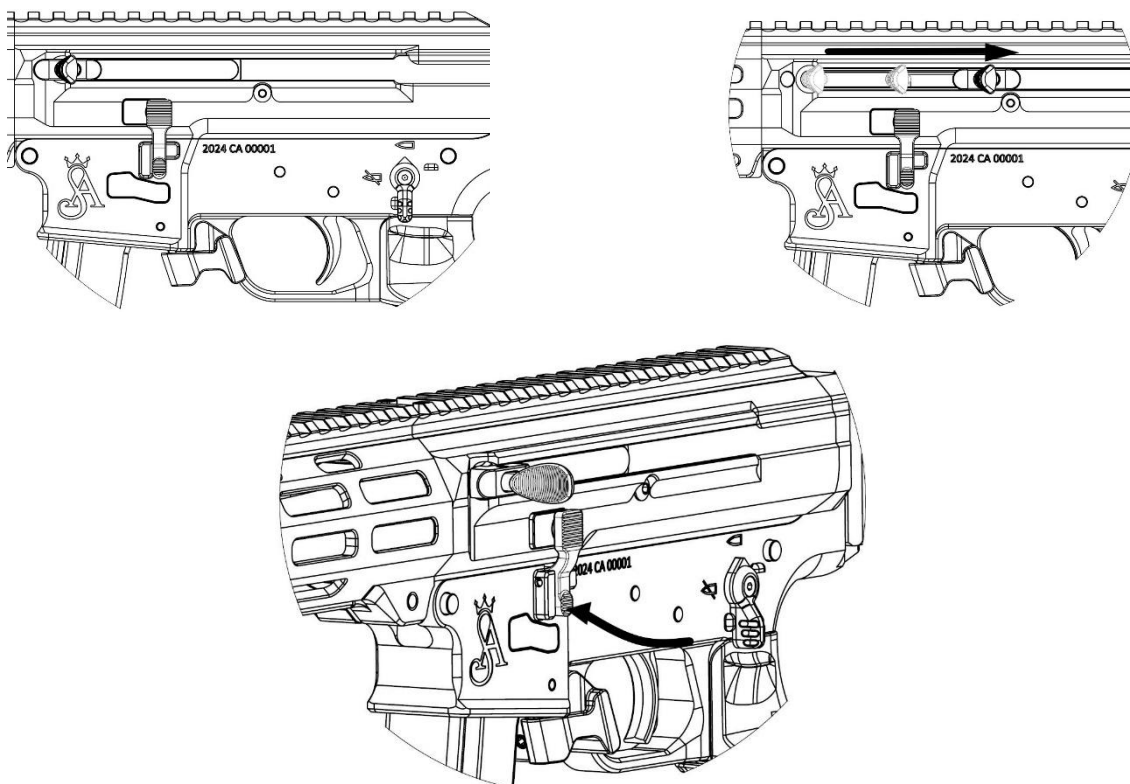

5. Look into the chamber to assure that it does not contain a cartridge. NEVER ASSUME THAT THE CHAMBER IS EMPTY UNTIL YOU HAVE VISUALLY EXAMINED IT AND SEE THAT IT IS EMPTY

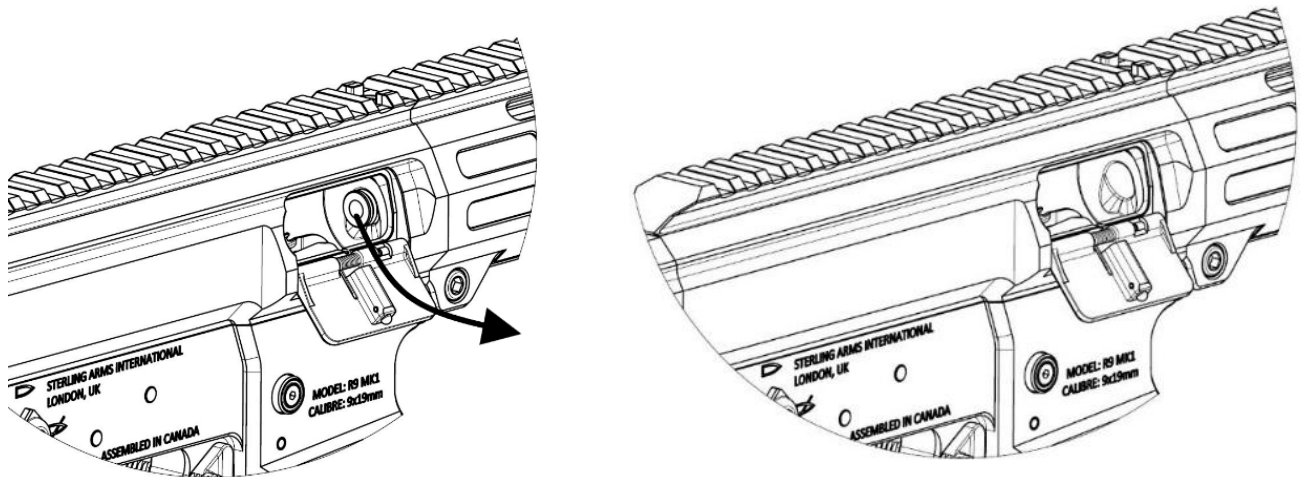

CAUTION: THE MAGAZINE MAY FALL FREE WHEN THE MAGAZINE CATCH IS PRESSED. DON'T ALLOW THE MAGAZINE TO FALL ONTO A HARD SURFACE. DOING SO MAY DAMAGE THE MAGAZINE.

## 10. DISASSEMBLY

**WARNING:** ALWAYS UNLOAD YOUR FIREARM BEFORE CLEANING, LUBRICATION, DISASSEMBLY, OR REASSEMBLY.

**WARNING:** ALWAYS WEAR SAFETY GLASSES WHEN DISASSEMBLING, MAINTAINING, OR ASSEMBLING YOUR FIREARM. IN PARTICULAR, THE OPERATING SPRING IS UNDER HIGH COMPRESSION. IF IT SLIPS FROM YOUR GRASP, IT COULD CAUSE INJURY.

**WARNING:** USE CARE OPENING THE ACTION: SWING THE UPPER RECEIVER AND BARREL GROUP DOWN TO DISASSEMBLE AND CLEAN THE RIFLE. KEEP YOUR FINGERS AWAY FROM THE FRONT OF THE RECEIVER WHEN LOWERING THE BARREL TO PREVENT PINCHING IT BETWEEN THE RECEIVER AND HANDGUARD.

## 10.A OPENING THE ACTION

1. Unload and PROVE the firearm safe.
2. Using a cleaning rod or cartridge tip, push from the left side on the Takedown Pin (L-23) until it extends fully to the right side of the rifle.

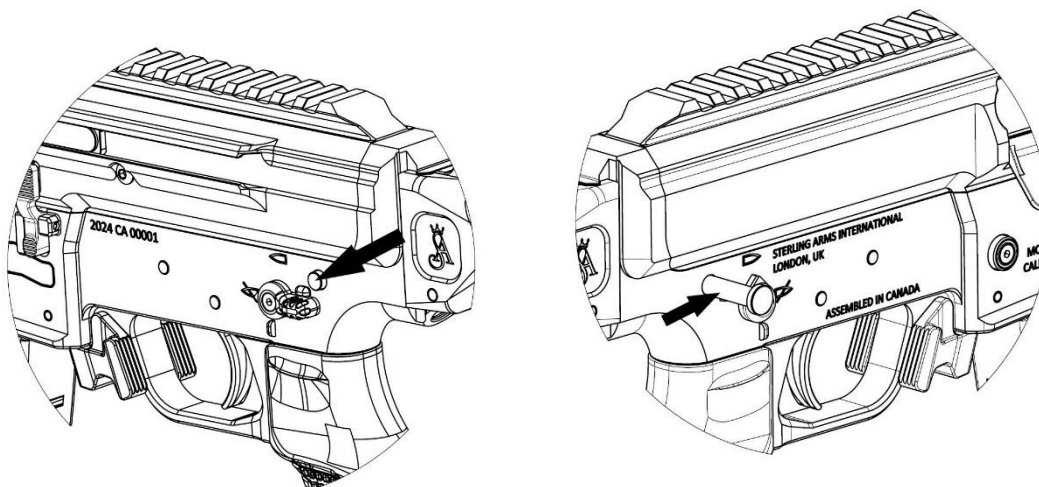

3. Using a cleaning rod or cartridge tip, push from the left side on the Pivot Pin (L-30) until it extends fully to the right side of the rifle. The upper receiver can now move towards the front and then lift off the lower receiver. Do so under control.

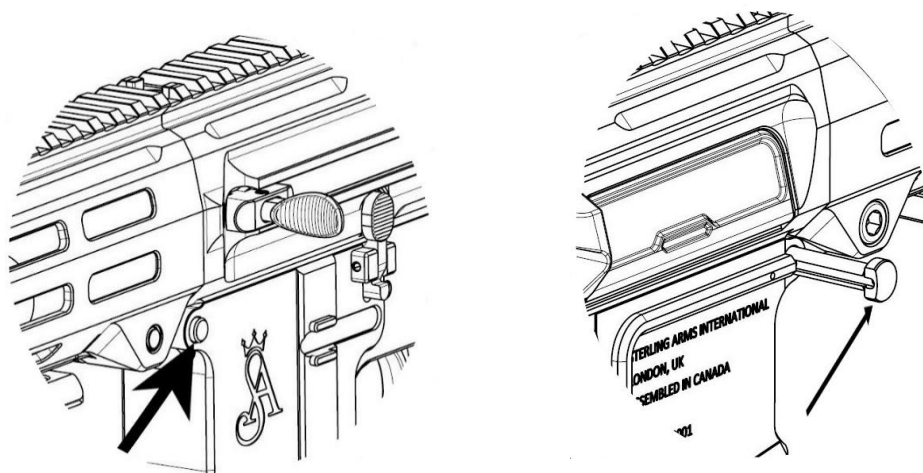

**CAUTION: DO NOT ALLOW THE RIFLE TO DROP OPEN. THE PIVOT PIN AREA MIGHT BE DAMAGED IF THE HANDGUARD STRIKES THE RECEIVER WITH TOO MUCH FORCE.**

4. Release pressure gradually on the Back plate (U-30) to prevent the recoil springs from propelling the guide rod assembly out of the receiver.

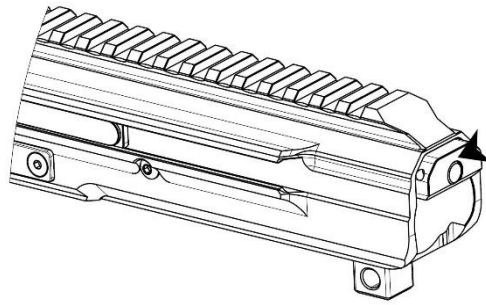

5. Pull the charging handle (U-33) to the rear. This will move; the guide rod assembly, guide rod spring and bolt assembly rearward allowing them to slide out of the upper receiver. It should not be necessary to separate the upper and lower receivers during normal cleaning.

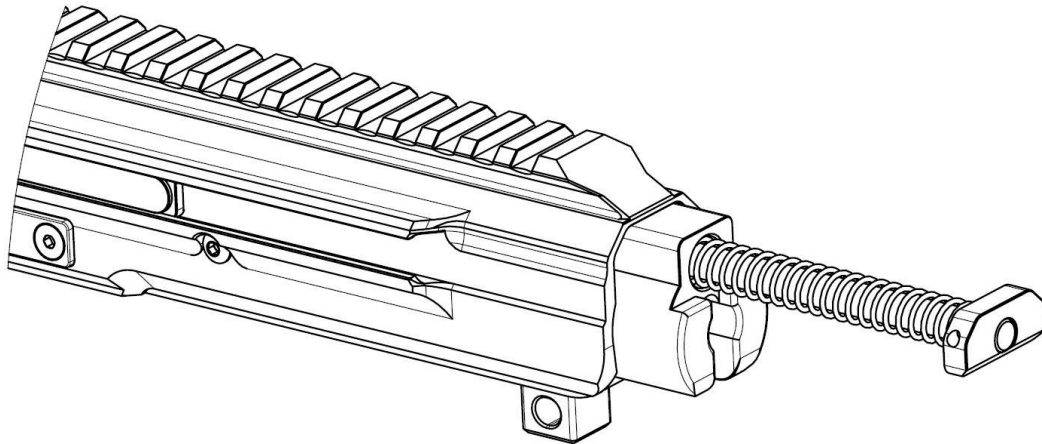

6. Remove the bolt assembly, guide rod, and guide rod spring.

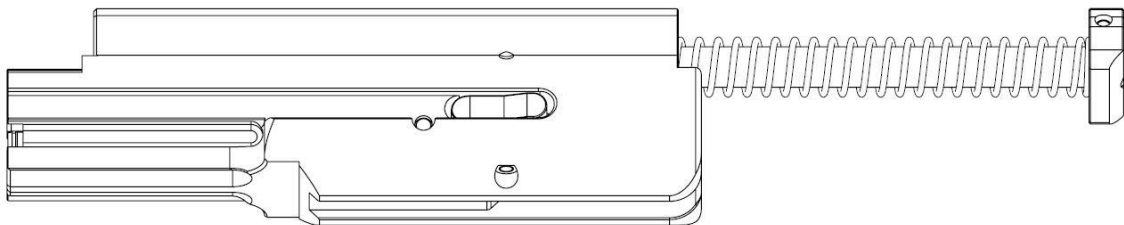

## 10.B BOLT CARRIER GROUP

1. Press forward from the metal plate behind the spring rod and you will see the protruding part in front of the bolt. Rotate approximately 45° counterclockwise and pull back. The spring will come off the bolt.

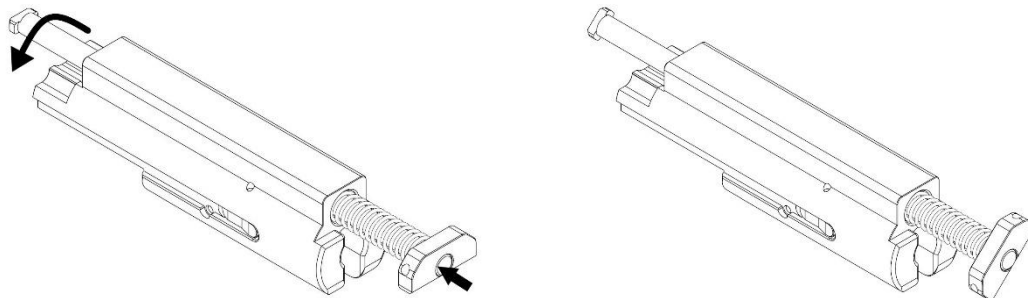

2. To reattach the spring; Insert the spring rod into the hole of the bolt, with the rounded corner of the metal plate behind the spring rod facing up. When the end of the metal rod protrudes from the other side, turn the rod clockwise. The protrusion on the rod end will fit into its bearing in the bolt.

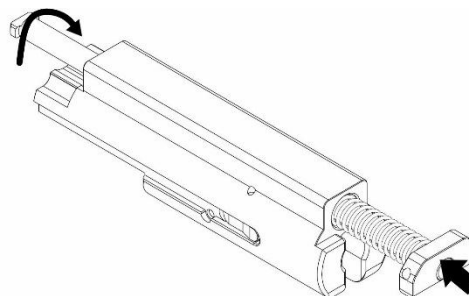

3. Remove the pin on the side of the bolt assembly to remove the firing pin.

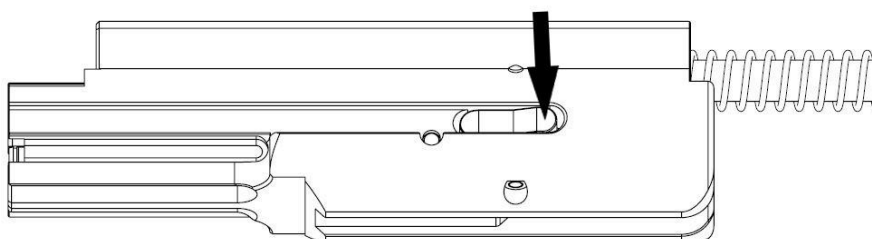
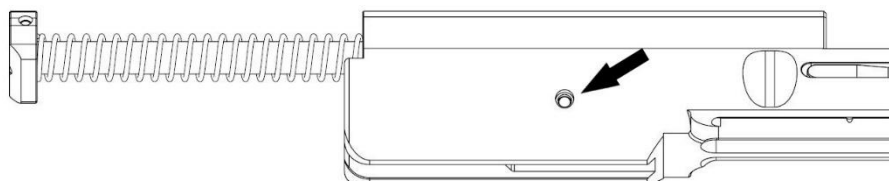

When the pin is removed, the firing Pin may pop out, take precautions or it may not come out by itself. If it does not come out, the firing pin safety catch is held by the latch and you can remove the firing pin by applying inward pressure on the rear face of the latch. Further disassembly is not required for normal cleaning.

## 10.B UPPER RECEIVER

Since the product working system is Simple blow Back, in case of need for cleaning or maintenance, you need to unscrew the upper rail and the screws at the bottom to remove the handguard. Other than this, there is no need for further disassembly.

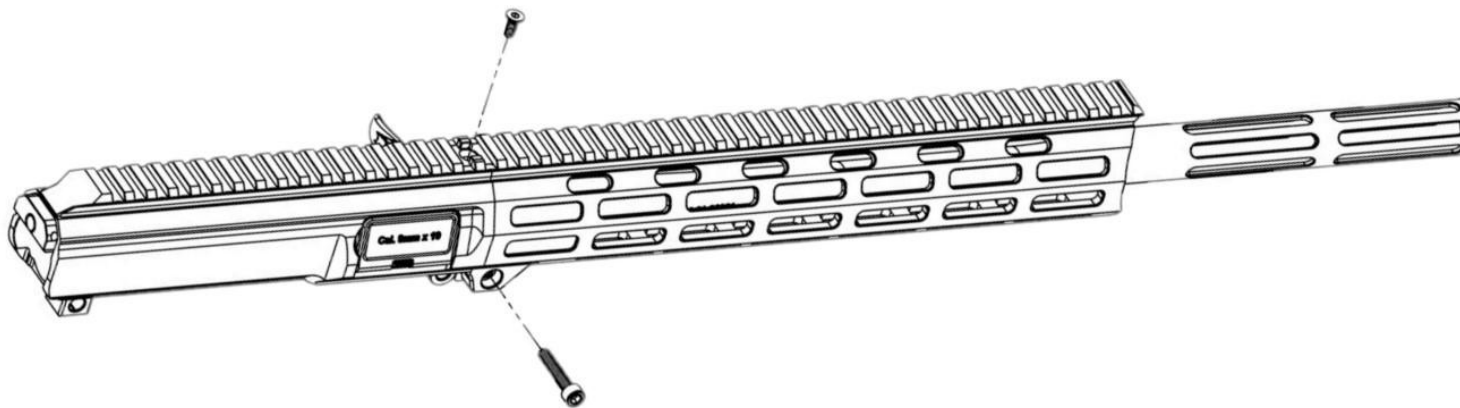

**Muzzle carbon cleaning can be added.**

**NO FURTHER DISASSEMBLY OF THE FIREARM IS REQUIRED OR ENCOURAGED.**

## 11. MAINTENANCE

**WARNING: ALWAYS UNLOAD YOUR FIREARM BEFORE CLEANING**

### 11.A LUBRICATION, DISASSEMBLY, OR REASSEMBLY.

To clean and maintain your SAI R9 MK1 rifle system, you will require:

Appropriate cleaners, solvents and protective oils.

A coated cleaning rod, a brass bore brush, a brass patch holder, a chamber / bore brush, lint free patches, small nylon and brass brushes and a lint free rag.

If the user is not already knowledgeable, seek assistance from a qualified source; such as your local firearms retailer.

### 11.B CLEANING LUBRICANTS AND LUBRICATION

The rifle should be cleaned and lubricated at the beginning and end of each day's use, or when exposed to an excessive amount of dirt, grit or other foreign matter and/or water. For most reliable continued

SAI R9 MK1 User's manual – ENGLISH – version 1

operation, all surfaces should be protected by a very light film of oil.

In low temperatures, use small amounts of a light oil or a powder graphite.

Use OIL/LUBRICANTS generously on the bolt assembly, paying particular attention to guide rods.

### **PROPER LUBRICATION WILL ENHANCE THE LONGEVITY OF YOUR RIFLE.**

Your SAI R9 MK1 ships with a sample of oil that is used in the factory.

## **12. REASSEMBLY**

The reassembly of the SAI R9 MK1 is a reversal of the disassembly procedure.

**Note:** The Hammer (L-39) **MUST** be in the cocked position to close the rifle.

**Note:** Be careful to ensure ALL parts removed during disassembly are also reinstalled during assembly.

**CAUTION:** DURING ASSEMBLY; ASSURE THAT THE FIRING PIN RETAINING SPRING IS INSTALLED (U-22). This spring ensures the FIRING PIN is not able to travel during the closing of the bolt and potentially cause an accidental discharge of a cartridge.

**WARNING:** ALWAYS UNLOAD YOUR FIREARM BEFORE CLEANING.

## **13. FUNCTION TEST / CHECK**

After reassembling the firearm, it is very important to conduct a basic FUNCTION CHECK to ensure that assembly was done properly. This test is done **WITHOUT** a magazine attached to the firearm.

**To conduct the FUNCTION TEST / CHECK:**

1. Pull the charging handle (U-33) to the rear and release it. **DO NOT** assist the bolt forward. It must travel on its own power.
2. Place the safety on "SAFE". Squeeze the trigger. The hammer should **NOT** fall.

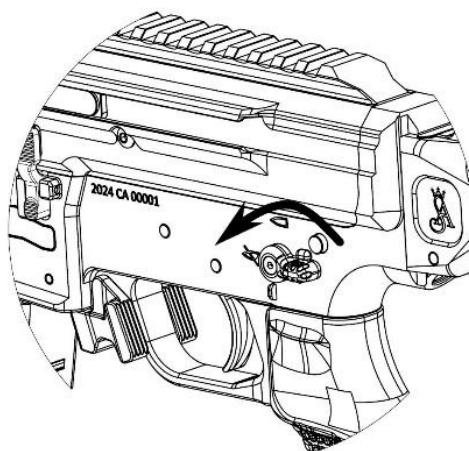
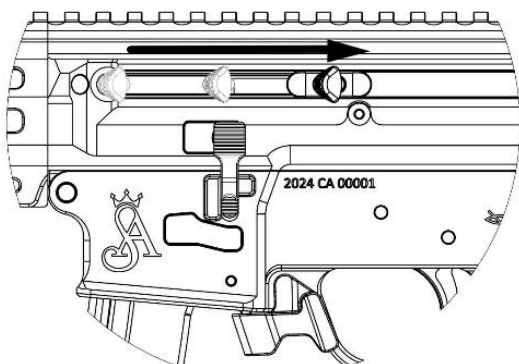



3. Place the safety on “FIRE”. Squeeze the trigger and hold it there. The hammer **SHOULD** fall. Keep holding the trigger to the rear.

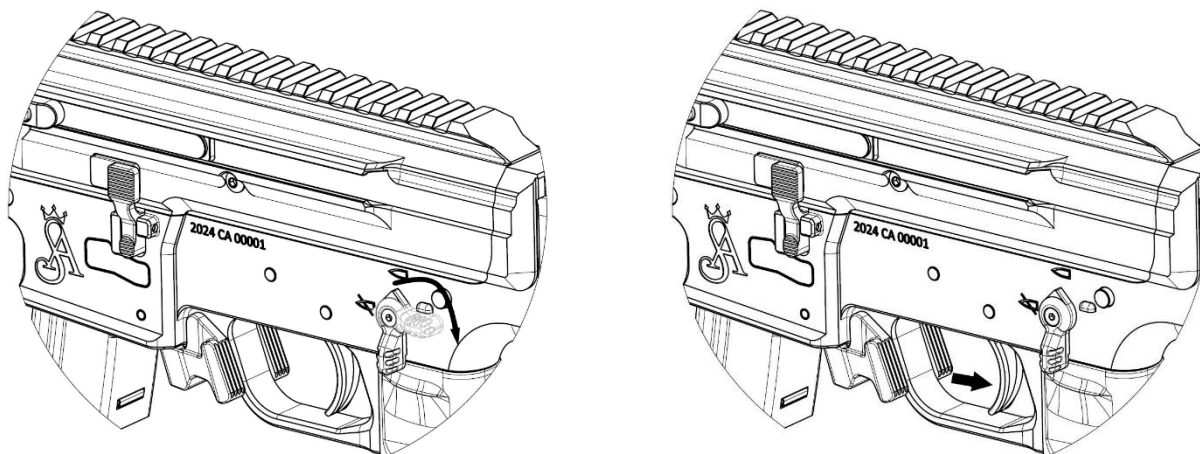

4. With a single motion, pull the charging handle (U -33) fully to the rear and release it; keeping the trigger depressed.

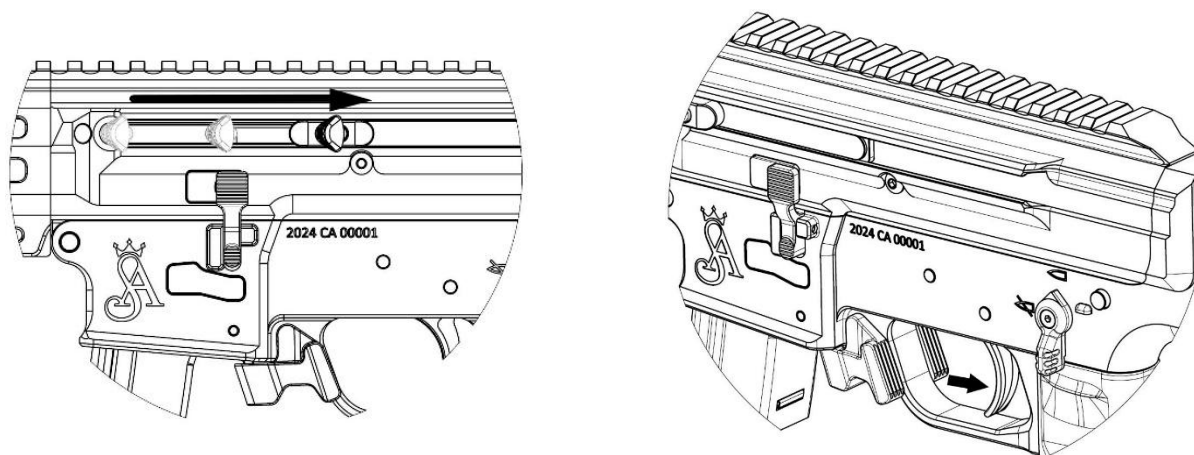

5. Release the trigger. You should hear a click as you release the trigger.  
6. Squeeze the trigger again and the hammer **SHOULD** fall.

If there is a failure at any step in this test: Disassemble the firearm and reassemble, paying close attention to ensure all of the parts and pieces are present and assembled correctly.

After a second reassembly, if there is still a failure in the function test; the firearm should be inspected by a qualified gunsmith or returned to the manufacturer for evaluation and repair if necessary.

**DO NOT ATTEMPT TO FIRE THE SAI R9 MK1 IF IT HAS FAILED THE FUNCTION TEST.**

## 14. TROUBLESHOOTING

<b>PROBLEM</b>	<b>CHECK FOR</b>	<b>WHAT TO DO</b>
<b>WILL NOT FIRE</b>	Safety on "SAFE"	Put it on "FIRE".
	Improper assembly of firing pin	Assemble correctly NOTE: the retaining pin goes behind large shoulder of firing pin.
	Too much oil around firing pin	Clean with pipe cleaner.
	Defective ammunition	Remove and discard.
	Too much carbon on firing pin or firing pin recess	Clean.
	Bolt not fully locked.	Extract cartridge, clean area.
<b>BOLT WILL NOT LOCK</b>	Dirty bolt	Clean.
	Burred or broken bolt	Contact SAI warranty centre
	Ejector stuck	Contact SAI warranty centre
	Dirt, corrosion, or carbon buildup in barrel locking lugs	Clean lugs
<b>WILL NOT EXTRACT</b>	Broken extractor spring	Replace.
	Inner spring or reinforcement ring missing from extractor spring	Replace.
	Dirty, corroded, or reloaded ammunition	Remove and discard.
	Carbon in chamber	Clean chamber.
	Frozen or worn extractor	Remove and clean.
	Restricted movement of bolt carrier assembly	Remove, clean and lubricate.
<b>WILL NOT FEED</b>	Dirty, corroded, or reloaded ammunition	Remove and discard.
	Dirty or defective magazine	Clean and lubricate or replace.
	Too many rounds in magazine	Remove excess rounds.
	Magazine not fully seated	Push magazine fully home.
<b>DOUBLE FEED</b>	Defective magazine	Replace

<b>WILL NOT CHAMBER</b>	Dirty corroded or defective ammunition	Remove and discard.
	Ejector stuck	Clean and oil.
	Carbon in chamber	Clean.
<b>SHORT RECOIL / STROKE</b>	Weak or reloaded ammunition	Replace with factory fresh ammunition.
	Dirty rifle	Clean.
	Improper lubrication	Lubricate generously
<b>BOLT FAILS TO LOCK OPEN AFTER LAST ROUND</b>	Defective magazine	Replace.
	Dirty or corroded bolt catch	Clean or replace.
	Weak or reloaded ammunition	Replace with factory fresh ammunition.
<b>SAFETY BINDS</b>	Needs oil	Lubricate.
	Dirt or sand under trigger.	Clean.
<b>BOLT CARRIER "HUNG UP" (HARD EXTRACTION)</b>	Round jammed between bolt and charging handle and/or double	<ol style="list-style-type: none"> <li>1. Remove magazine.</li> <li>2. Push in on bottom of bolt catch.</li> <li>3. Bang rifle butt on ground, bolt should shift to rear.</li> <li>4. While bolt is held to rear, round should fall out through magazine well.</li> </ol> <p>NOTE: If this procedure fails, use a cleaning rod to push bolt fully to the rear through the ejection port.</p>

## 15. WARRANTY, SERVICE, AND SUGGESTIONS

Be sure to keep your sales receipt. If no original dated receipt is available, the warranty date starts on the date that the firearm was sold to the first person or business from Sterling Arms International, Inc. or and is valid for 365 days from that point. SAI's records will be the basis for all warranty disputes.

**The Standard warrant for a SAI rifle is ONE YEAR from the date of original purchase.**

If a rifle is received outside of this timeframe, all work will be billed as per posted and established SAI rates.

Customer is responsible for shipping the firearm and the firearm remains the customer's responsibly until SAI acknowledges receipt of delivery.

If a repair is found to be under warranty, shipping and insurance to return the rifle back to the customer will be prepaid by SAI or a representative.

Returns for any reason will NOT be accepted without a Return Merchandise Authorization (RMA) number issued by SAI or its representative agency.

After you receive your RMA number, print it on the outside of the box and include a short note in the box. The note should include the RMA number, your name, address, email, phone number, the model and serial number of the firearm you're returning, and a detailed explanation of the problems that you're having with the firearm. Remove any accessories (scope, scope mount, sling, bipod, cleaning equipment, etc.) that don't pertain to your problems before you send the firearm in. If you have any functional problem with the firearm, do send the magazines with it.

**Before seeking warranty service:** use the troubleshooting guide in this Operator's Manual to attempt to solve the problem, perform all instructed maintenance, and assure that ammunition and magazines are correct and in good condition. Shop rates plus the cost of return shipping will be applied if no covered defect is found.

**WARNING:** BEFORE SHIPPING ENSURE THE FIREARM IS UNLOADED.

**WARNING:** NEVER SHIP LIVE AMMUNITION WITH ANY FIREARM THAT YOU ARE RETURNING FOR SERVICE.

**WARNING:** IT IS THE OWNER'S RESPONSIBILITY TO ASSURE THAT ANY PARTS THAT ARE PURCHASED FROM SAI IS CORRECTLY FITTED AND INSTALLED. IMPROPER FITTING OR INSTALLATION MAY RESULT IN INJURY, DEATH, OR DAMAGE/MALFUNCTION OF THE FIREARM.

**A copy of the owner's manual for any SAI firearm is available free in the Library on the SAI website or may be obtained free in hard copy by contacting SAI directly. Additional technical information can be found in Technical Notes in the Library section of the SAI website.**